



Service Parts Kits

Pump Models

PP63C17 SC63C17 VP63C17
PP64C17 SC64C17 VP64C17

The mechanical seal kit and bearing frame kit are offered separately. We recommend ordering both kits for a major service.

Both the Mechanical Seal and Bearing Frame kits include all of the O-rings needed for service.

Part Number	Description
372000104	Mechanical Seal Kit, includes O-rings
373000108	Bearing Frame Kit, includes O-rings



PN 372000104 Mechanical Seal Kit

Qty	Item #	Description
4	30148018	O-Ring, Oil Return
1	30148160	O-Ring, Seal Gland
1	30148165	O-Ring, Bearing Cap/SAE
1	30148258	O-Ring, Brac-plate
2	30148386	O-Ring, Volute/Suction Cover
1	30400172	Mechanical Seal
1	12227112	Impeller Key
1	37500121	Impeller Lock Washer
1	30500179	Cassette Seal
1	34800105	Loctite 263, 0.5ML
1	34800104	P-80 Lubricant, 10ML

PN 373000108 Bearing Frame Kit

Qty	Item #	Description
1	12721101	Shim 6.28 X 5.50 X .005
1	12721102	Shim 6.28 X 5.50 X .010
1	12721103	Shim 6.28 X 5.50 X .015
1	31900101	Pump End Bearing
2	31900202	Drive End Bearing
1	32000102	Washer, Bearing
1	32100102	Nut, Bearing
4	30148018	O-Ring, Oil Return
1	30148160	O-Ring, Seal Gland
1	30148165	O-Ring, Bearing Cap/SAE
1	30148258	O-Ring, Brac-plate
2	30148386	O-Ring, Volute/Suction Cover
3	31858118	Tapered Rubber Plug
1	30500176	Cassette Seal
2	30500179	Cassette Seal

Service Parts Kits

Pump Models

PP63C17 SC63C17 VP63C17

PP64C17 SC64C17 VP64C17

Ordering Information

Parts Kits are in stock and available for shipment within 2 business days.

Please call or fax orders. Phone (503) 266-4115, Fax (503) 266-4116.

Email: Canbyparts@pioneerpump.com.

Part Number	Description
372000104.....	Mechanical Seal Service Kit
373000108.....	Bearing Frame Service Kit

Optional Parts

Additional parts for this model.

Model	Description	Part Number
63C17	Wear Ring	10902459
63C17	Impeller, CA6NM SS	112301883
64C17	Wear Ring	109023766
64C17	Impeller, CA6NM SS	112305985

Seal Installation Tool for 2.50" Shafts

63C17/64C17 Installation Tool3671710236B

Notes:

1. Part numbers listed reflect updated part numbers as of May 11, 2016. Older documentation may have different part numbers. Please consult factory if differences appear.
2. Viton O-rings are included when available.



310 South Sequoia Parkway, Canby, OR 97013 USA

Phone (503) 266-4115 ■ Fax (503) 266-4116

www.pioneerpump.com

Parts Drawing - 372000104 Mechanical Seal Parts Kit

Pump Models

PP63C17 SC63C17 VP63C17

PP64C17 SC64C17 VP64C17

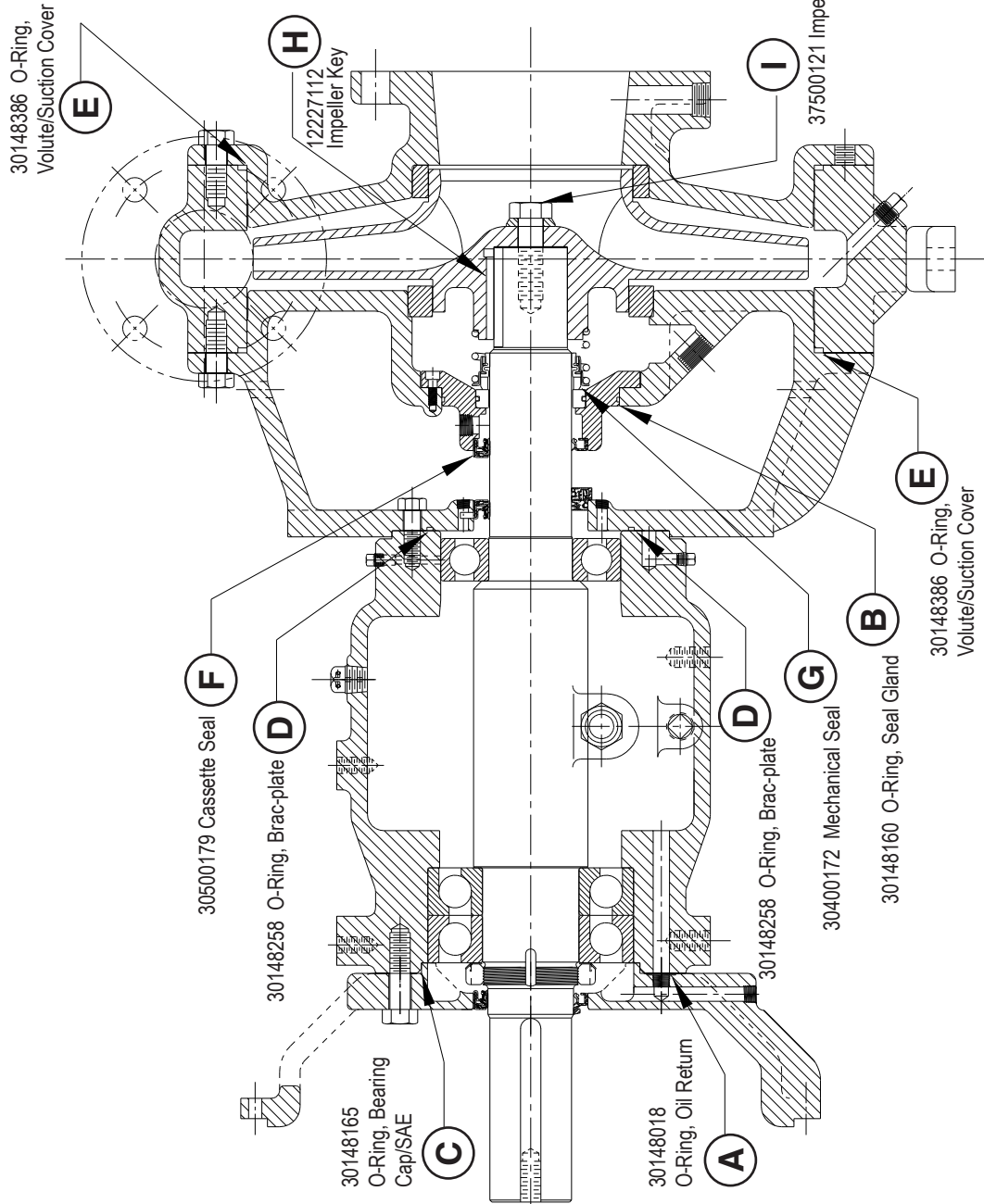

PN 372000104 Mechanical Seal Kit

Ref.	Item Number	Description	Qty.
A	30148018	O-Ring, Oil Return	4
B	30148160	O-Ring, Seal Gland	1
C	30148165	O-Ring, Bearing Cap/SAE	1
D	30148258	O-Ring, Brac-plate	1
E	30148386	O-Ring, Volute/Suction Cover	2
F	30500179	Cassette Seal	1
G	30400172	Mechanical Seal	1
H	12227112	Impeller Key	1
I	37500121	Impeller Lock Washer*	1
N/A	34800104	P-80 Lubricant, 10 mL	1
N/A	34800105	Loctite 263, 0.5 mL	1

*Torque Specification: 330 lb-ft



310 South Sequoia Parkway, Canby, OR 97013 USA
 Phone (503) 266-4115 ■ Fax (503) 266-4116
www.pioneerpump.com

Parts Drawing - 373000108 Bearing Frame Kit

Pump Models

PP63C17 SC63C17 VP63C17
 PP64C17 SC64C17 VP64C17

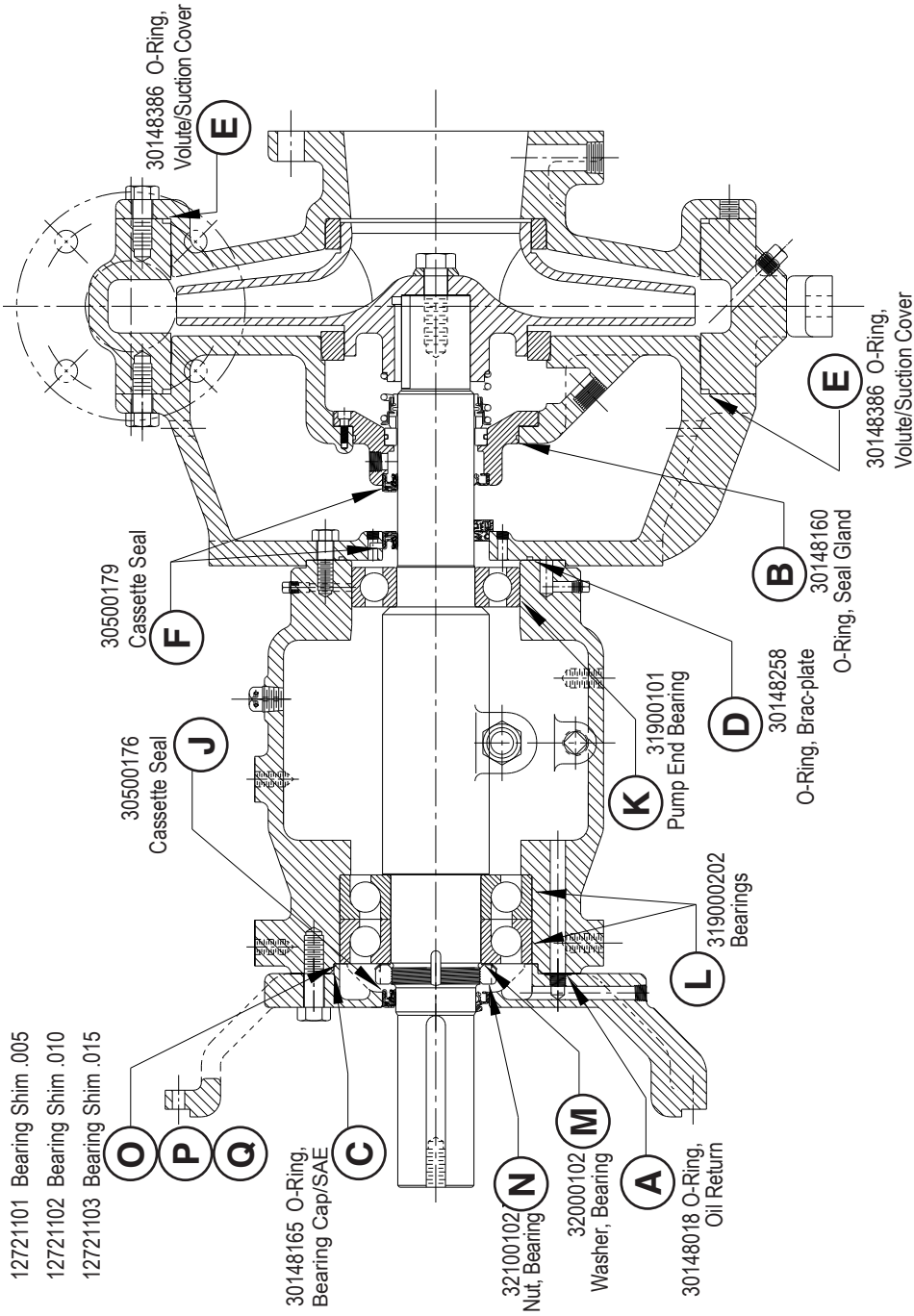

PN 373000108 Bearing Frame Kit

Ref. Item Number	Description	Qty.
A	30148018 O-Ring, Oil Return	4
B	30148160 O-Ring, Seal Gland	1
C	30148165 O-Ring, Bearing Cap/SAE	1
D	30148258 O-Ring, Brac-plate	1
E	30148386 O-Ring, Volute/Suction Cover	2
F	30500179 Cassette Seal	2
J	30500176 Cassette Seal	1
K	31900101 Pump End Bearing	1
L	31900202 Drive End Bearing	2
M	32000102 Washer, Bearing	1
N	32100102 Nut, Bearing	1
O	12721101 Shim, .005 Thick	1
P	12721102 Shim, .010 Thick	1
Q	12721103 Shim, .015 Thick	1
N/A	31858118 Tapered Rubber Plug	3



310 South Sequoia Parkway, Canby, OR 97013 USA
 Phone (503) 266-4115 ■ Fax (503) 266-4116
www.pioneerpump.com