

The mechanical seal kit and bearing frame kit are offered separately. We recommend ordering both kits for a major service.

Both the Mechanical Seal and Bearing Frame kits include all of the O-rings needed for service.



Part Number	Description
372000109	Mechanical Seal Repair Kit, includes O-rings
373000107	Bearing Frame Repair Kit, includes O-rings

PN 372000109 Mechanical Seal Kit

Qty	Item #	Description
1	30400172	Mechanical Seal
1	12721113	Shim 1.69 X .66 X .005
1	12721114	Shim 1.69 X .66 X .010
1	12721115	Shim 1.69 X .66 X .015
4	30148018	O-Ring, Drain Back
4	30148112	O-Ring, Bracket Capscrew
1	30148160	O-Ring, Carrier
1	30148165	O-Ring, Bearing Cover
1	30148273	O-Ring, Bracket
1	30148336	O-Ring, Cleanout Cover
1	30148379	O-Ring, Bracket
1	30148381	O-Ring, Volute
1	12227118	Key 3/8 X 3/8 X 1.63 Lg
1	34800104	P-80 Lubricant, 10ML
1	34800105	Loctite 263, 0.5ML
1	37500111	Lock Washer Kit
1	30500179	Cassette Seal

PN 373000107 Bearing Frame Kit

Qty	Item #	Description
1	31900101	Bearing
1	31900103	Bearing
1	32100102	Nut, Bearing
1	12721101	Shim 6.28 X 5.50 X .005
1	12721102	Shim 6.28 X 5.50 X .010
1	12721103	Shim 6.28 X 5.50 X .015
1	32000102	Washer, Bearing
1	12100101	Wave Spring
4	30148018	O-Ring, Drain Back
4	30148112	O-Ring, Bracket Capscrew
1	30148160	O-Ring, Carrier
1	30148165	O-Ring, Bearing Cover
1	30148273	O-Ring, Bracket
1	30148336	O-Ring, Cleanout Cover
1	30148381	O-Ring, Volute
3	31858118	Tapered Rubber Plug
1	30500176	Cassette Seal
2	30500179	Cassette Seal

Service Parts Kits

	Pump Models		
	PP44S10	SC44S10	VP44S10

Ordering Information

Parts Kits are in stock and available for shipment within 2 business days.
Please call or fax orders. Phone (503) 266-4115, Fax (503) 266-4116.
Email: Canbyparts@pioneerpump.com.

Part Number	Description
372000109.....	Mechanical Seal Repair Kit
373000107.....	Bearing Frame Repair Kit

Optional Parts

Additional parts for this model.

Model	Description	Part Number
44S10	Wear Ring	10902242
44S10	Impeller, CA6NM SS	11230158

Seal Installation Tool for 2.50" Shafts

44S8/44S10.....	Installation Tool	3671710236B
-----------------	-------------------------	-------------

Notes:

1. Part numbers listed reflect updated part numbers as of May 11, 2016. Older documentation may have different part numbers. Please consult factory if differences appear.
2. Viton O-rings are included when available.



310 South Sequoia Parkway, Canby, OR 97013 USA
Phone (503) 266-4115 ■ Fax (503) 266-4116
www.pioneerpump.com

Parts Drawing - 372000109 Mechanical Seal Parts Kit

Pump Models
PP44S10
SC44S10
VP44S10

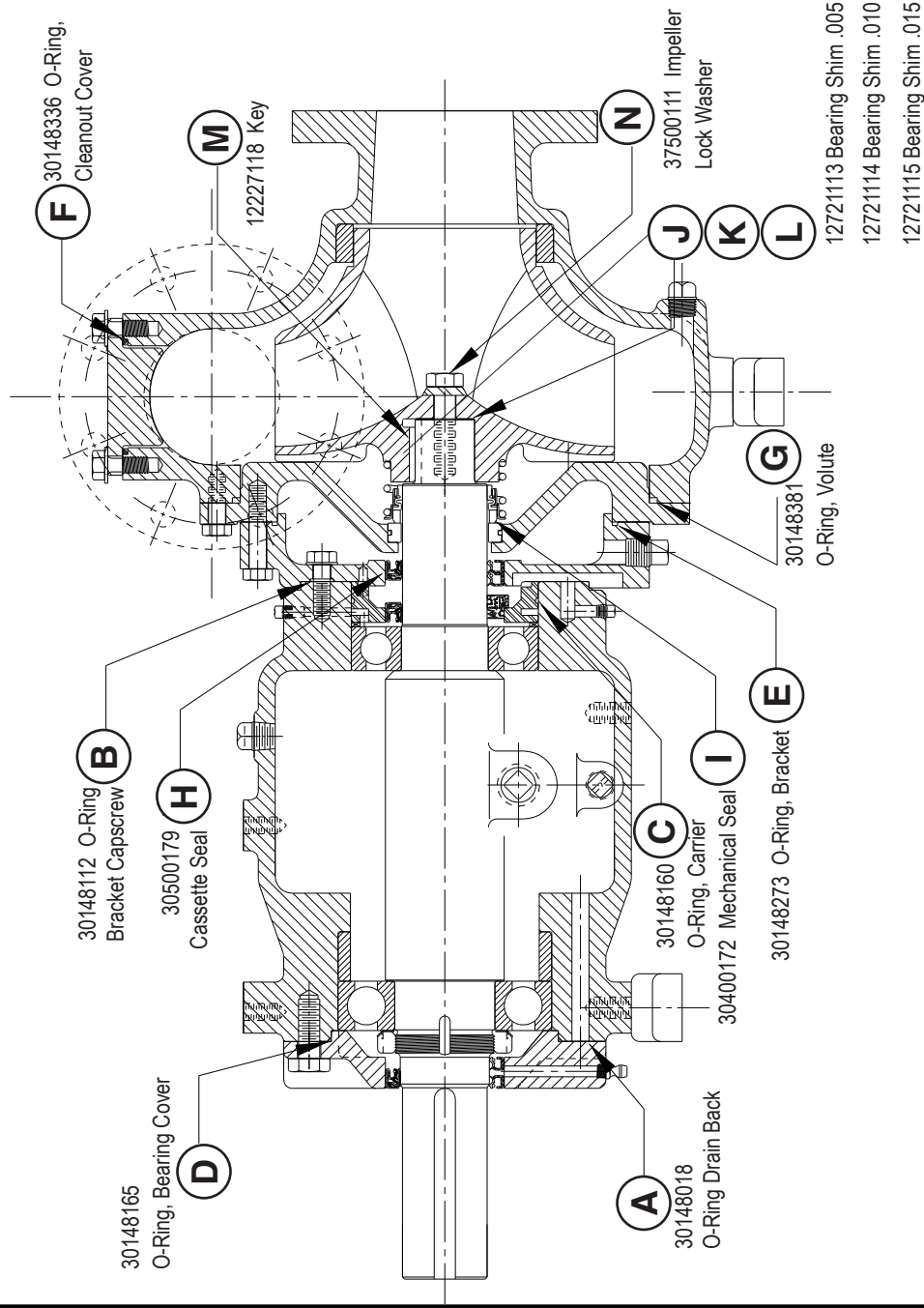

*Torque Specification: 180 lb-ft

Ref. Item Number	PN 372000109 Mechanical Seal Kit Description	Qty.
A	30148018 O-Ring, Drain Back	4
B	30148112 O-Ring, Bracket Capscrew	4
C	30148160 O-Ring, Carrier	1
D	30148165 O-Ring, Bearing Cap/SAE	1
E	30148273 O-Ring, Bracket	1
F	30148336 O-Ring, Cleanout Cover	1
G	30148381 O-Ring, Volute	1
H	30500179 Cassette Seal	1
I	30400172 Mechanical Seal	1
J	12721113 Shim, .005 Thick	1
K	12721114 Shim, .010 Thick	1
L	12721115 Shim, .015 Thick	1
M	12227118 Impeller Key	1
N	37500111 Impeller Lock Washer*	1
N/A	34800104 P-80 Lubricant, 10 mL	1
N/A	34800105 Loctite 263, 0.5 mL	1



310 South Sequoia Parkway, Canby, OR 97013 USA
 Phone (503) 266-4115 ■ Fax (503) 266-4116
www.pioneerpump.com

Parts Drawing - 373000107 Bearing Frame Kit

Pump Models
PP44S10
SC44S10
VP44S10

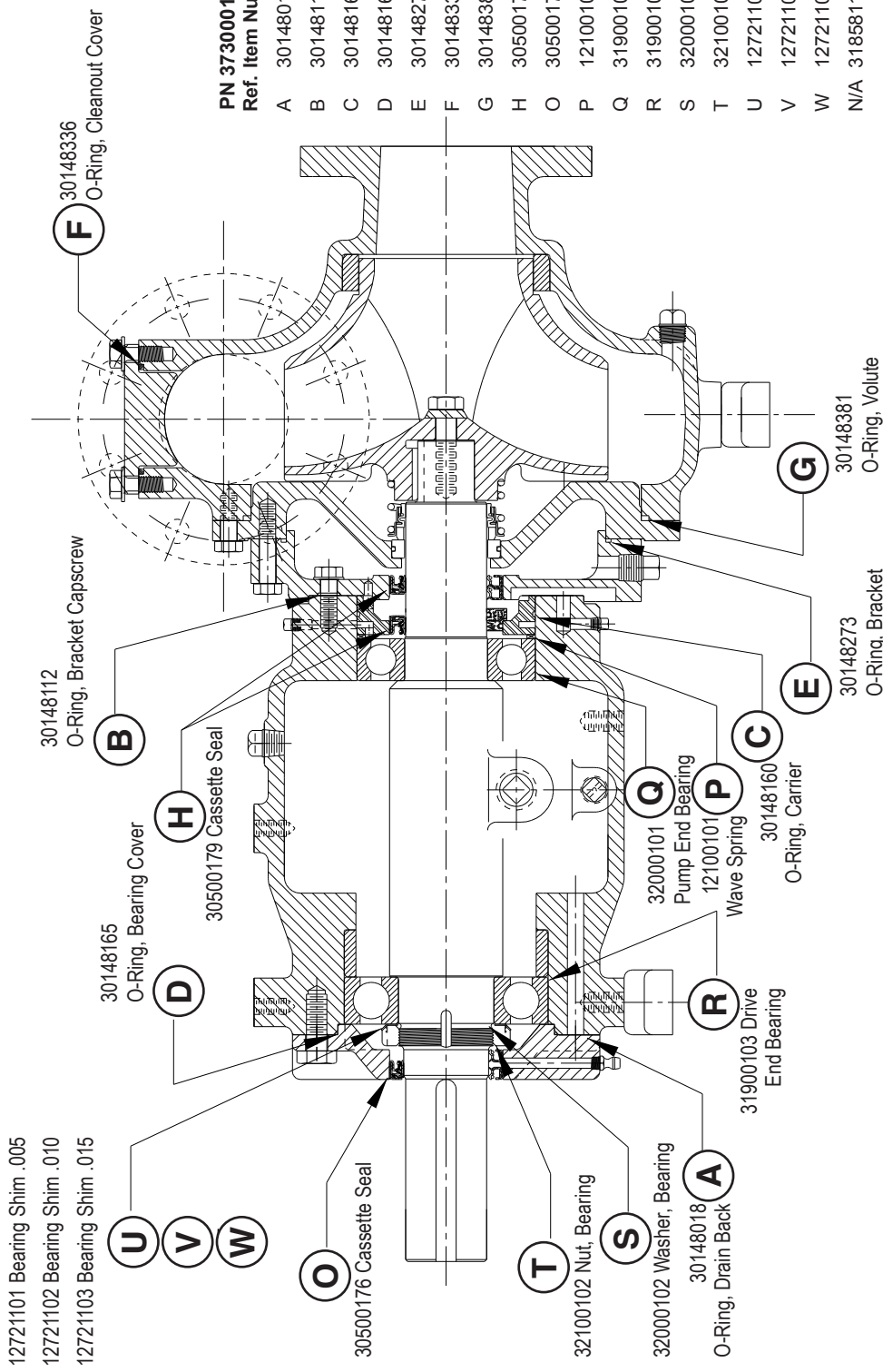

PN 373000107 Bearing Frame Kit			
Ref. Item Number	Description	Qty.	
A	30148018 O-Ring, Drain Back	4	
B	30148112 O-Ring, Bracket Capscrew	4	
C	30148160 O-Ring, Carrier	1	
D	30148165 O-Ring, Bearing Cap/SAE	1	
E	30148273 O-Ring, Bracket	1	
F	30148336 O-Ring, Cleanout Cover	1	
G	30148381 O-Ring, Volute	1	
H	30500179 Cassette Seal	2	
O	30500176 Cassette Seal	1	
P	12100101 Wave Spring	1	
Q	31900101 Pump End Bearing	1	
R	31900103 Drive End Bearing	1	
S	32000102 Washer, Bearing	1	
T	32100102 Nut, Bearing	1	
U	12721101 Shim, .005 Thick	1	
V	12721102 Shim, .010 Thick	1	
W	12721103 Shim, .015 Thick	1	
N/A	31858118 Tapered Rubber Plug	3	



310 South Sequoia Parkway, Canby, OR 97013 USA
 Phone (503) 266-4115 ■ Fax (503) 266-4116
www.pioneerpump.com